

Courses Down Yellow Bretches Ck. from a Small Beach at this * to a post at P. viz.

- N 43 W 18
 - N 7 W 15
 - N 28 E 12
 - East 68.9
 - N 17 E 26.
 - N 2 1/2 E 22.
 - N 42 E 25
 - N 57 E 13
 - N 84 E 18
 - N 4 E 26
 - N 16 W 20
 - North 10
 - N 34 E 24
 - N 24 E 36
 - N 38 E 21
 - N 59 E 36
 - N 68 E 24
 - S 80 E 23
 - S 45 E 26
 - S 26 E 20
 - S 20 W 22 505.9 perches
- Total on the Creek

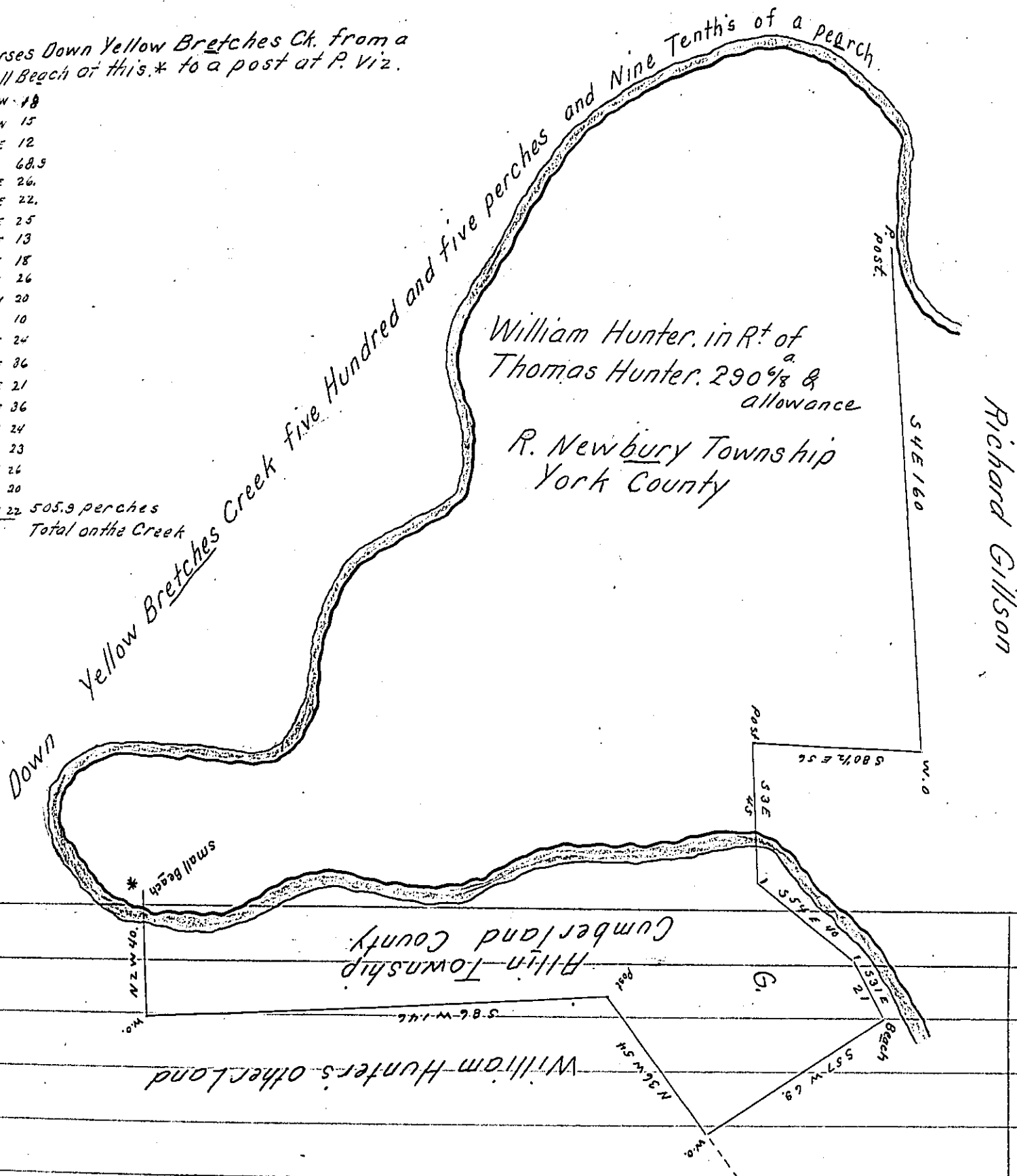

A Draught of a Tract of land Situate as is above Set forth Resurveyed the 27th day of May 1794. by the lines formerly Run in Pursuance of a Warrant to Thomas Hunter, Dated the 5th day of July 1745. Containing Two Hundred and Ninety Acres and Six Eighths of an Acre & the usual Allowance of Six Acres p. Cent for Roads.

John Forsyth D.S.

To Daniel Brodhead Esq. }
 Surveyor General

IN TESTIMONY that the above is a copy of the original remaining on file in the Department of Internal Affairs of Pennsylvania, made conformably to an Act of Assembly approved the 16th day of February, 1833, I have hereunto set my Hand and caused the Seal of said Department to be affixed at Harrisburg, this twenty fourth day of March 1905,

Loac R. Brown
 Secretary of Internal Affairs.